

DANPALON - NZBC E2/AS1

Scope Details

CONTENTS

<u>Title</u>	<u>Drawing No.</u>	<u>Page</u>
Components 1 & 2		2
Components 3 - 6		3
Components 7 - 10		4
Gutter/Wall Isometric	01	5
Eaves Detail	02	6
Roof/Wall Ridge Flashing	03	7
Hip & Ridge Flashing	04	8
Barge Detail	05	9
Parallel Apron Flashing	06	10
Hidden Gutter	07	11
Valley Gutter	08	12
Sheet Overlap Joint	09	13
Roof Penetrations	10	14
Transverse Apron Flashing	11	15
Cladding Corners	12	16
Horizontal Cladding Joint	13	17
Wall Cladding to Balcony	14	18
Wall Cladding to Deck	15	19
Cladding to Ground	16	20
Wall Cladding Penetration	17	21
Vertical Cladding - Ext. Connectors	18	22
Vertical Cladding - Internal Connectors	19	23
Vertical Glazing - Head & Sill	20	24
External Corner Detail	21	25
Hardy Mullion	22	26
AB Bar	23	27

Aug 2007

1 - SHEETS

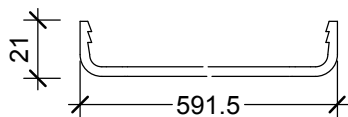

1A - Danpalon 4mm compact (592mm width)
11980mm length



1B - Danpalon 8mm multicell (600mm width)
11980mm length

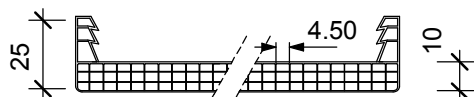

1C - Danpalon 10mm multicell (600mm width)
11980mm length

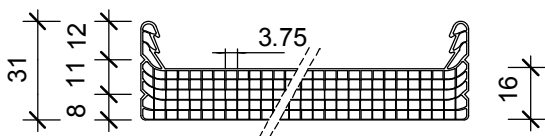

1D - Danpalon 16mm multicell (600mm width or
1040mm width) 11980mm length

2 - CONNECTORS AND SPACERS

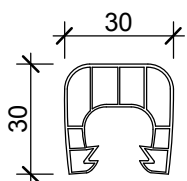

2PC - Danpalon polycarbonate connector for multicell
11980mm length

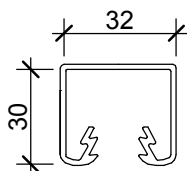

2AL1 - Danpalon standard aluminium connector for multicell
7000mm length - mill, anodised or powdercoated finish

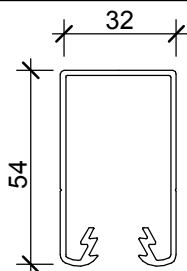

2AL2 - Danpalon heavy-duty aluminium connector for multicell
11980mm length - mill, anodised or powdercoated finish

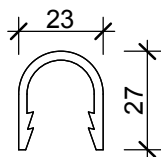

2CPC - Danpalon polycarbonate connector for compact
11980mm length

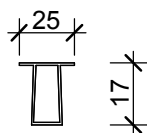

2CSP - Danpalon polycarbonate spacer for compact
11980mm length

3 - CONNECTOR CAPS

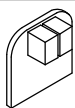

3PC - Danpalon polycarbonate connector end cap

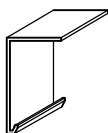

3AL - Danpalon aluminium connector end cap

4 - ALUMINIUM F-SECTIONS

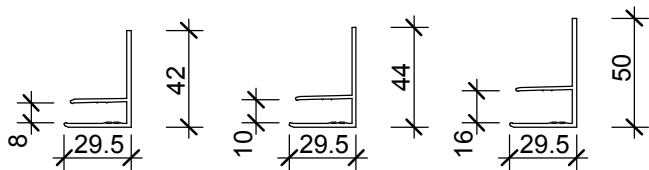

4 - Danpalon aluminium F section (8, 10 and 16mm multicell) 6500mm length

5 - SHEET CAPS



5PC - Danpalon polycarbonate end cap (8, 10 and 16mm multicell) 3000mm length

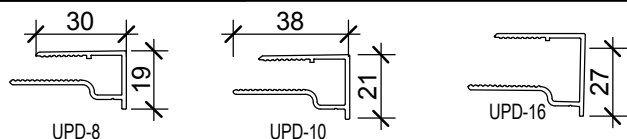

5AL - Danpalon aluminium end cap (8, 10 and 16mm multicell) 3000mm & 6000mm lengths

6 - FASTENERS FOR MULTICELL

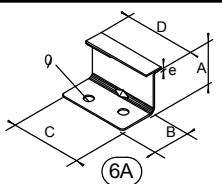

6A - Danpalon stainless steel (304) Heavy Duty Knee Fastener (8, 10 and 16mm multicell)

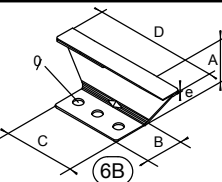

6B - Danpalon stainless steel (304) Trapezoidal Fastener (10 and 16mm multicell)

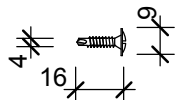

6C - Danpalon Wafer screw (for SS fasteners only)
Timber 12x50 (packet of 50), Metal 12x45 (packet of 50)

SS FASTENERS

	heavy-duty				trapezoidal	trapezoidal
	8	8	10	16	10	16
A	22	26	28	35	28	35
B	20	20	20	20	20	20
C	38	38	38	38	40	40
D	38	38	38	38	80	80
Ø	5	5	5	5	5	5
e	0.8+0.5				1+0.5	1+0.5

7 - FASTENERS FOR COMPACT

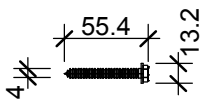

7 - Danpalon fixing screw through spacer (4mm compact only)
Timber 12x50 (packet of 50), Metal 12x45 (packet of 50)

8 - COMPACT RETENTION PLATE

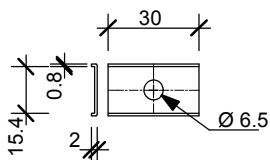

8 - Danpalon stainless steel (304) DP4mm Compact Retention Plate

9 - COMPRESSIBLE FOAM

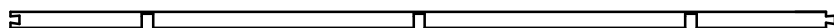

9 - Danpalon Foam infill - 40mm high x
24mm wide x 1800mm length

10 - AD3400 ANTI DUST TAPES

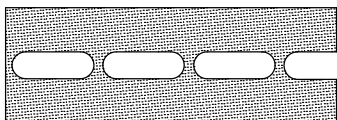

10A - Breather Tape (38mm
or 43mm wide x 33m long)

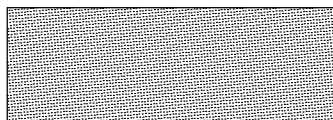

10B - Blanking Tape (38mm
or 43mm wide x 50m long)

11 - STRUCTURAL SUPPORT BARS

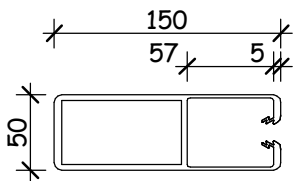

11A - Hardy Mullion Support Bar
6000mm length - mill, anodised or powdercoated finish
spans up to 4m

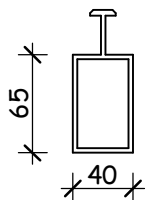

11B - Danpalon AB Bar
6000mm length - mill, anodised or powdercoated finish
can be roll formed to a 2.5m radius
can be used with 4mm, 8mm & 10mm Danpalon sheeting

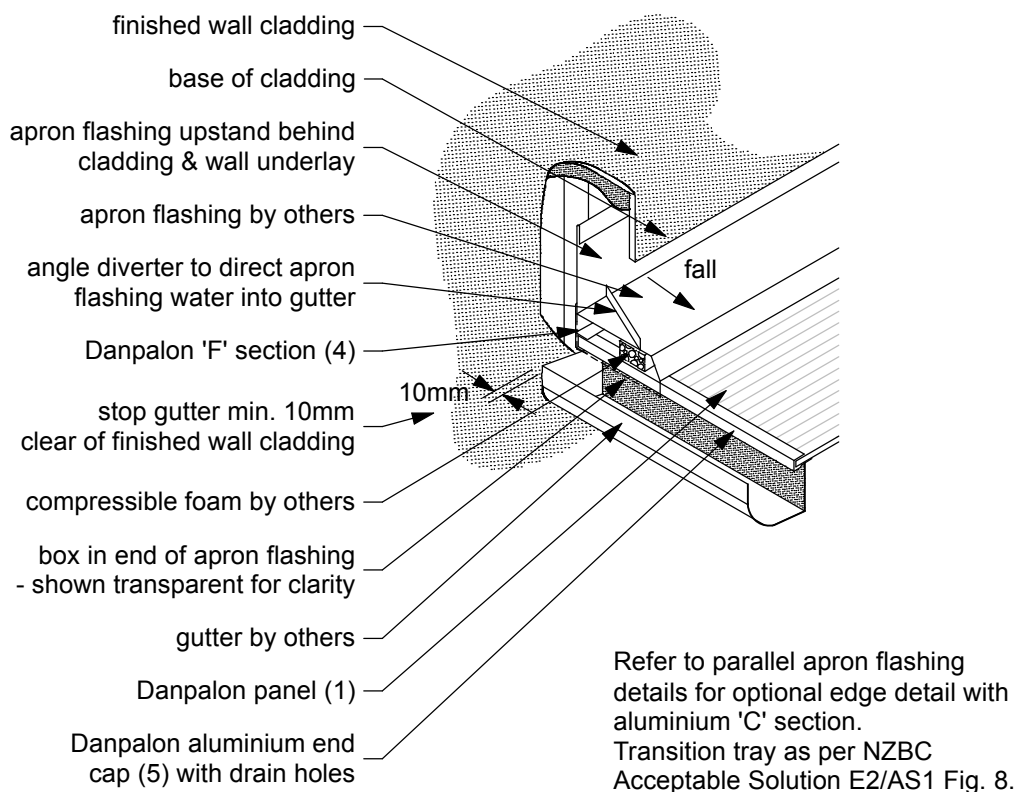

GUTTER/WALL JUNCTION

(isometric view from above)

Note: Reference Detail Figure 8
Acceptable Solution E2/AS1

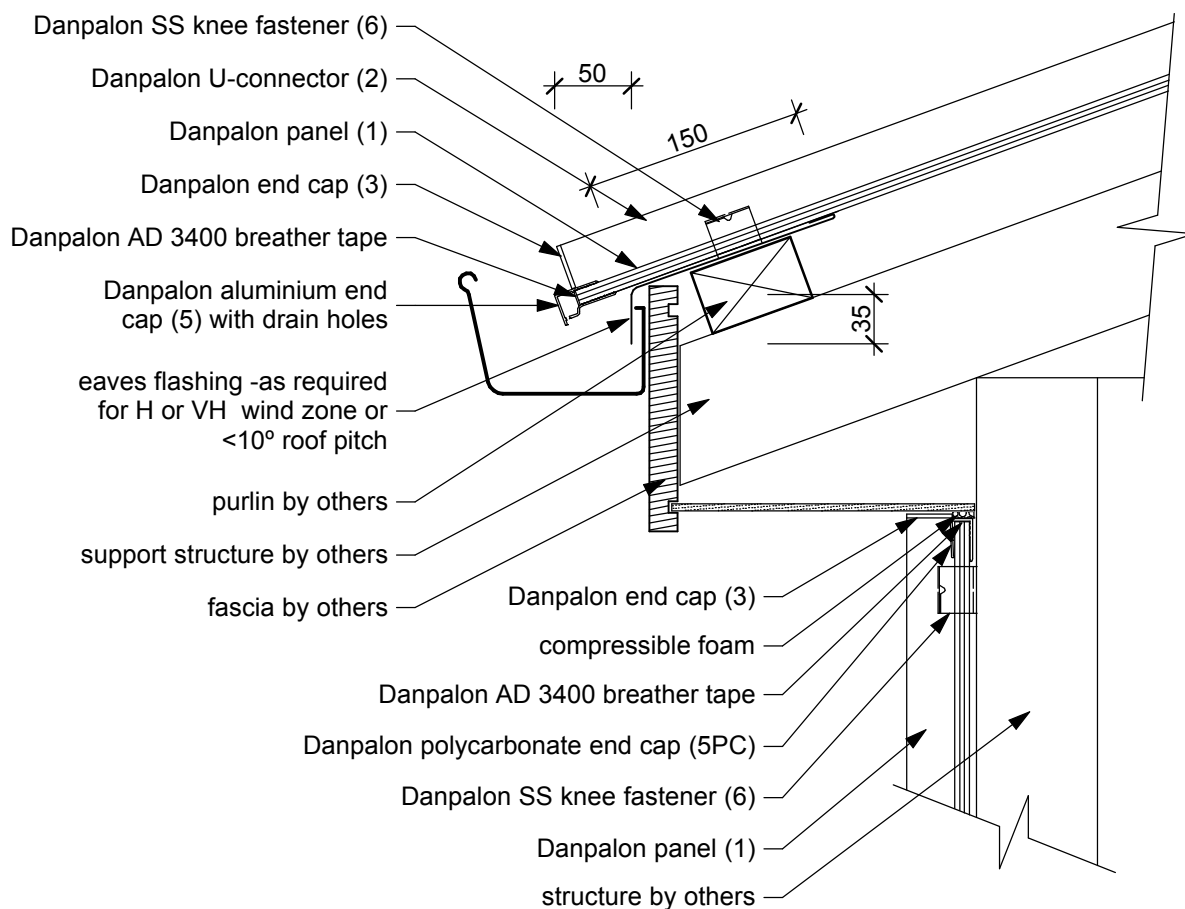

EAVES DETAIL

1:5

Note: Reference Detail Figure 45
Acceptable Solution E2/AS1.

X = 130mm in L, M, & H wind zones
 where roof pitch is greater than 10°
 X = 200mm for VH wind zones or roof
 pitch of 5°-10°

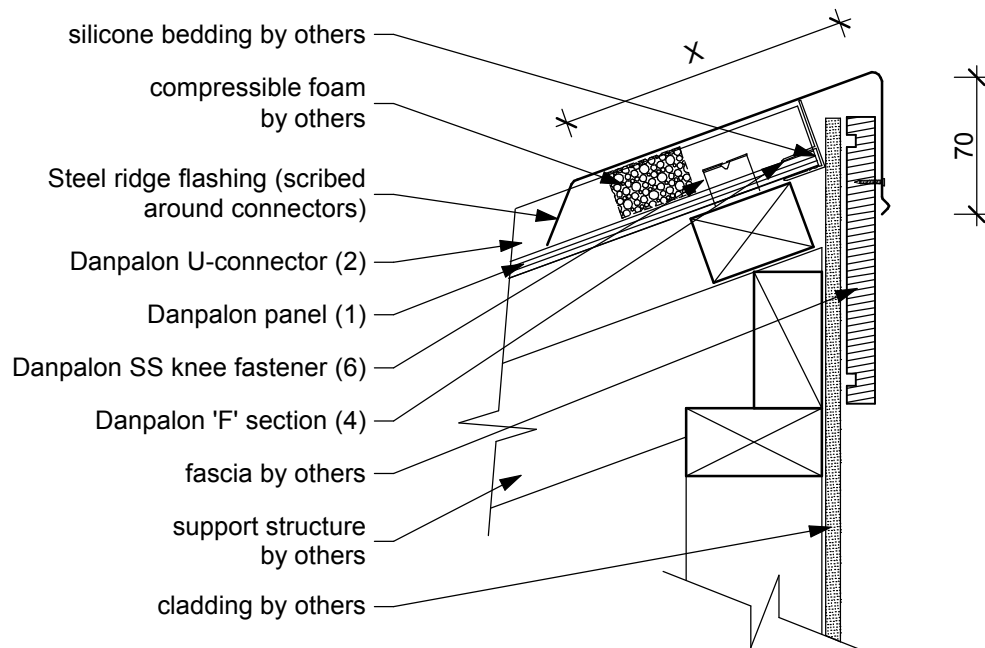

ROOF/WALL RIDGE FLASHING

1:5

Note: Reference Detail Figure 45
 Acceptable Solution E2/AS1.

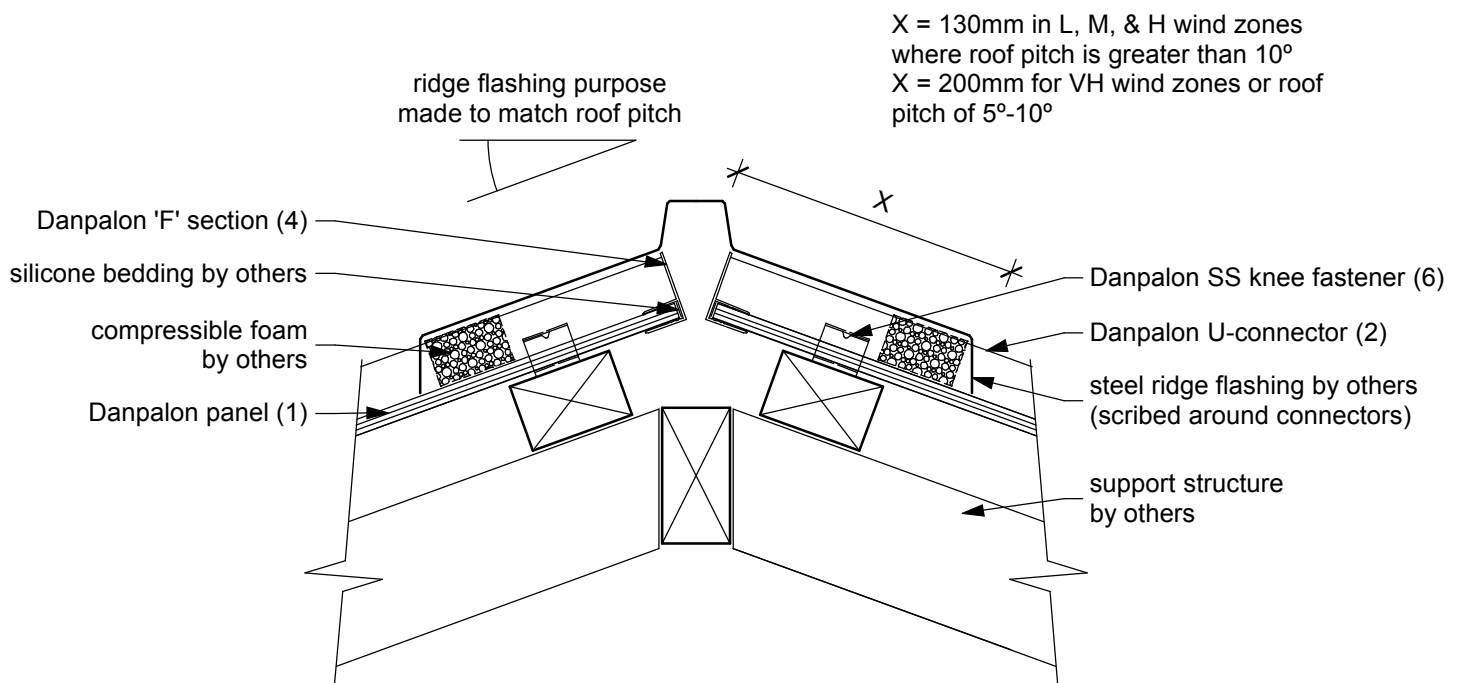

HIP & RIDGE FLASHING

1:5

Note:
Reference Detail Figure 46
Acceptable Solution E2/AS1.

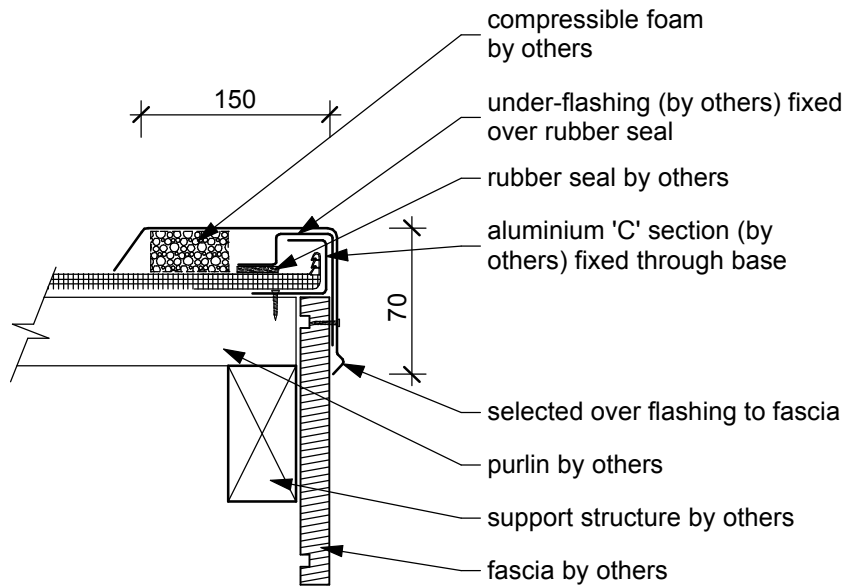

WHOLE SHEET WITH UPSTAND

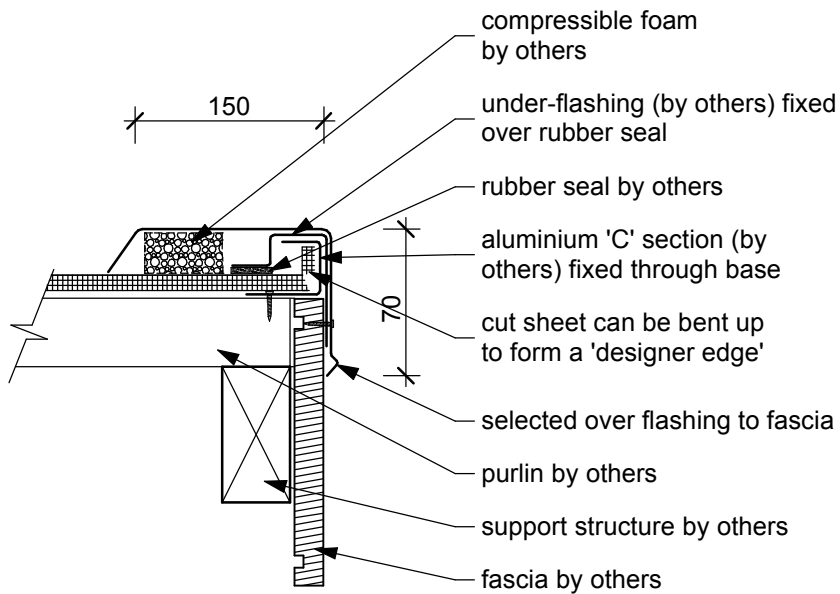

CUT SHEET WITH UPSTAND

BARGE DETAIL

1:5

Note: Reference Detail Figure 47
Acceptable Solution E2/AS1.

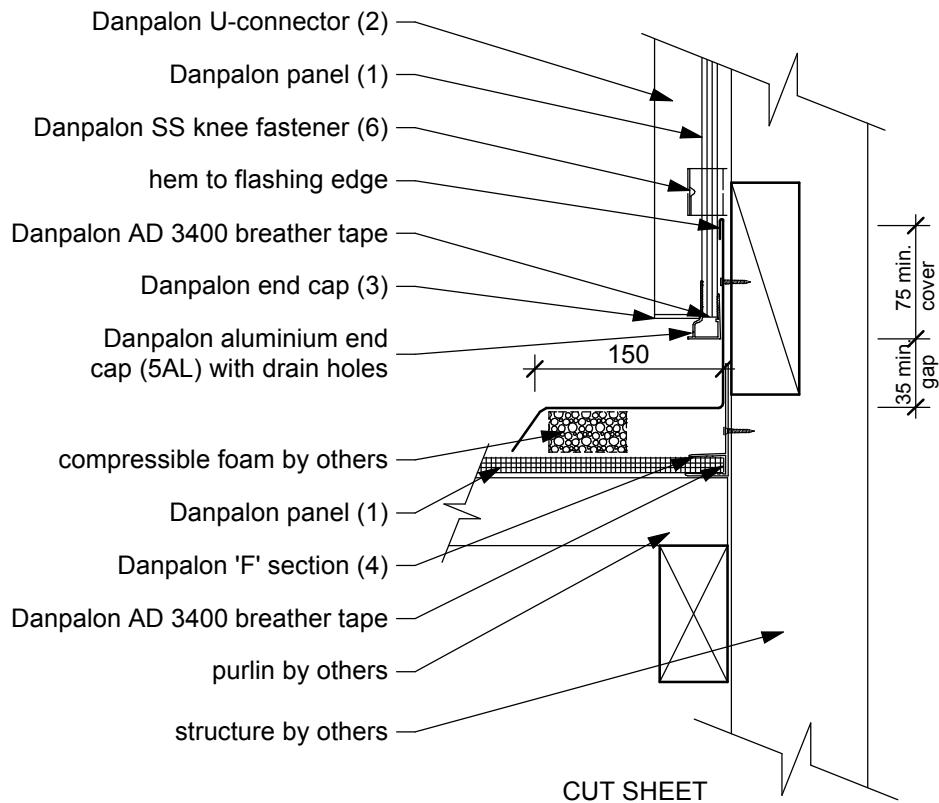
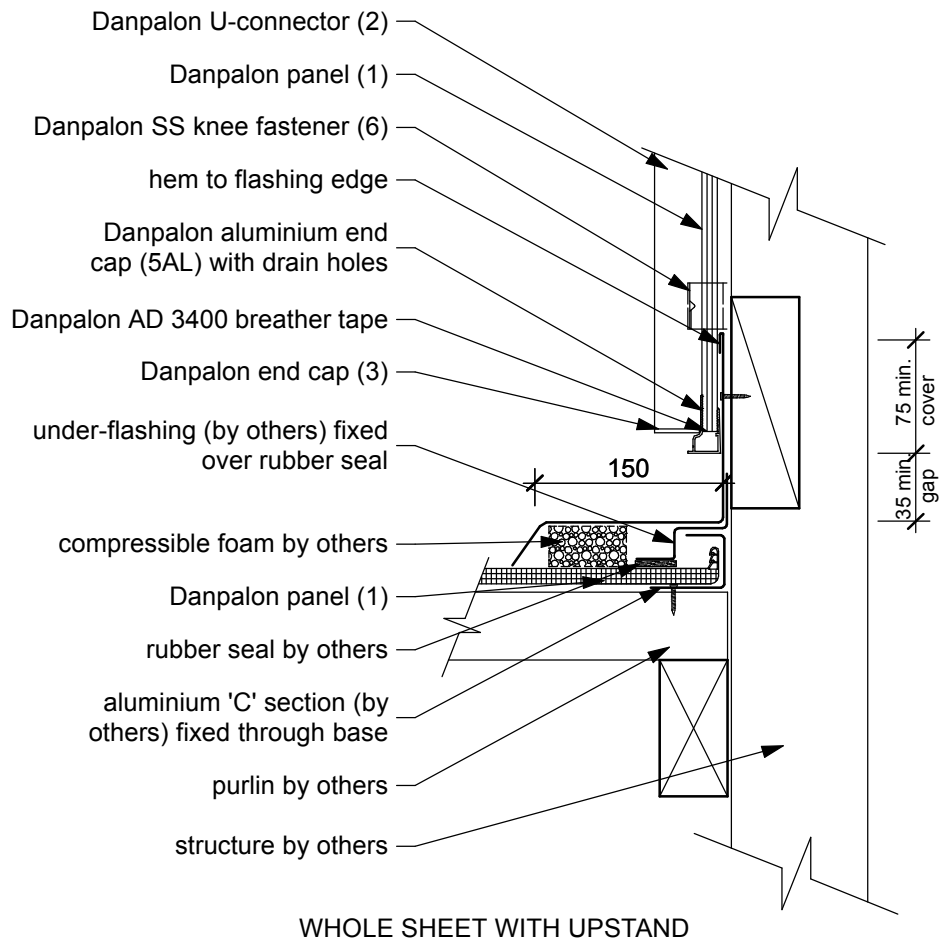

PARALLEL APRON FLASHING

1:5

Note: Reference Detail Figure 48
Acceptable Solution E2/AS1.

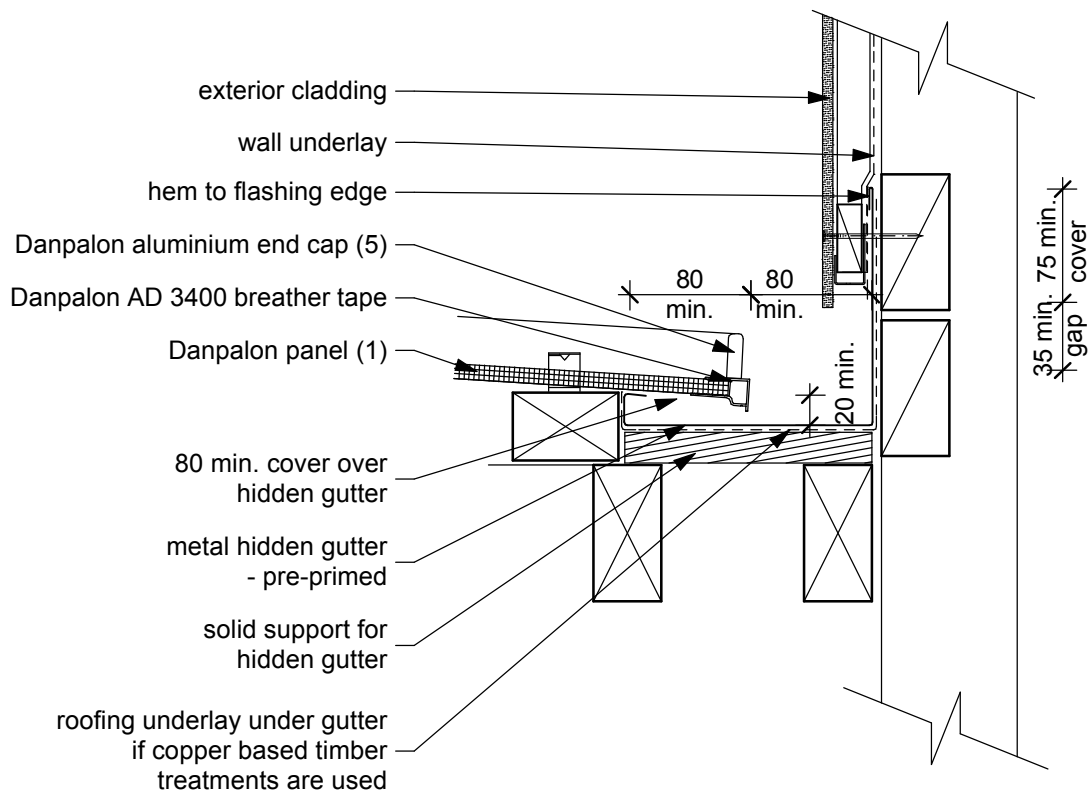

HIDDEN GUTTER

1:5

Note:
Reference Detail Figure 50
Acceptable Solution E2/AS1

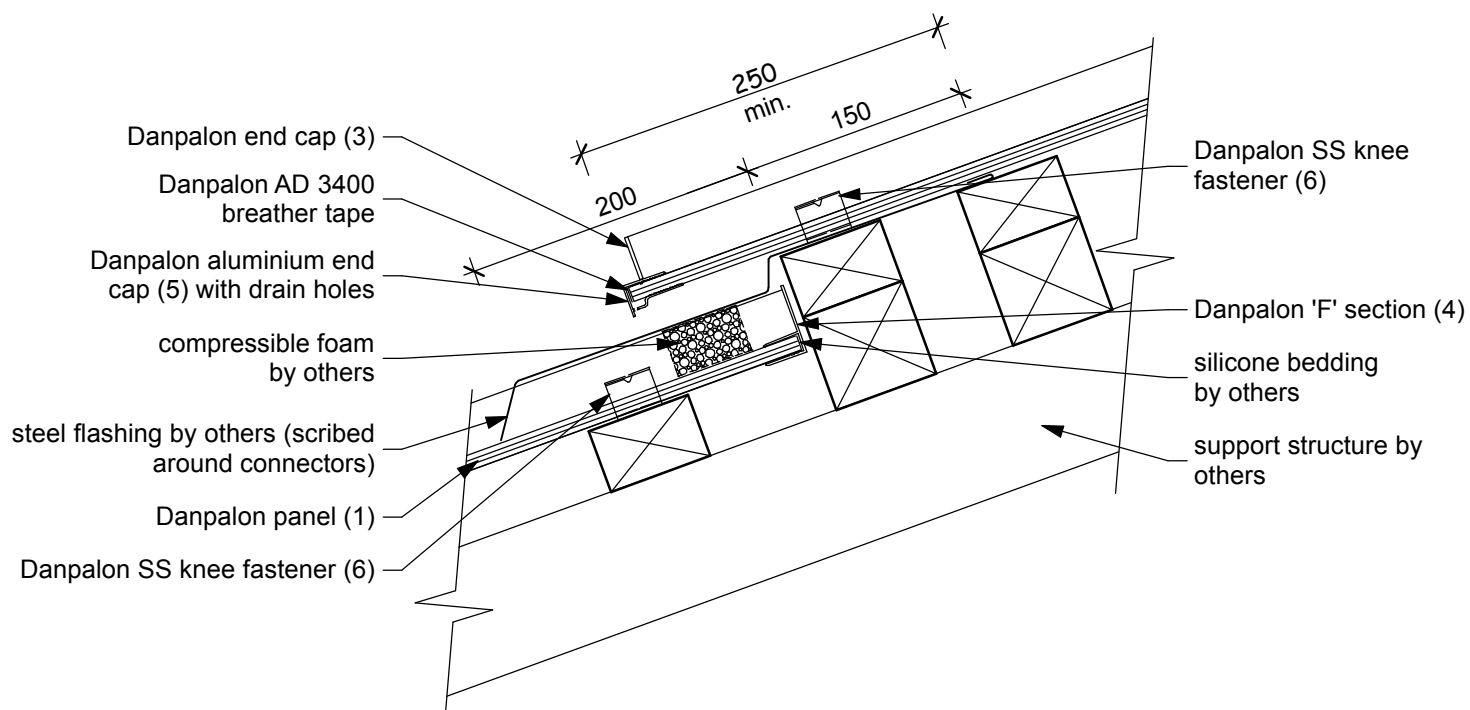

SHEET OVERLAP JOINT

1:5

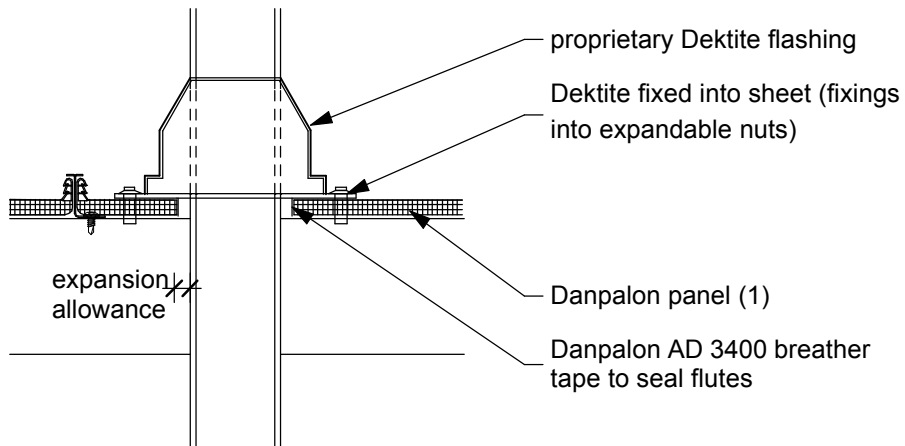
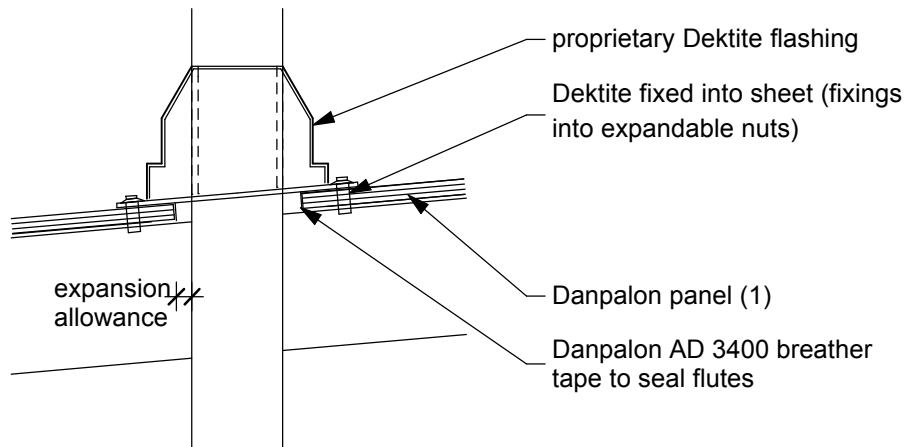

ROOF PENETRATIONS

1:5

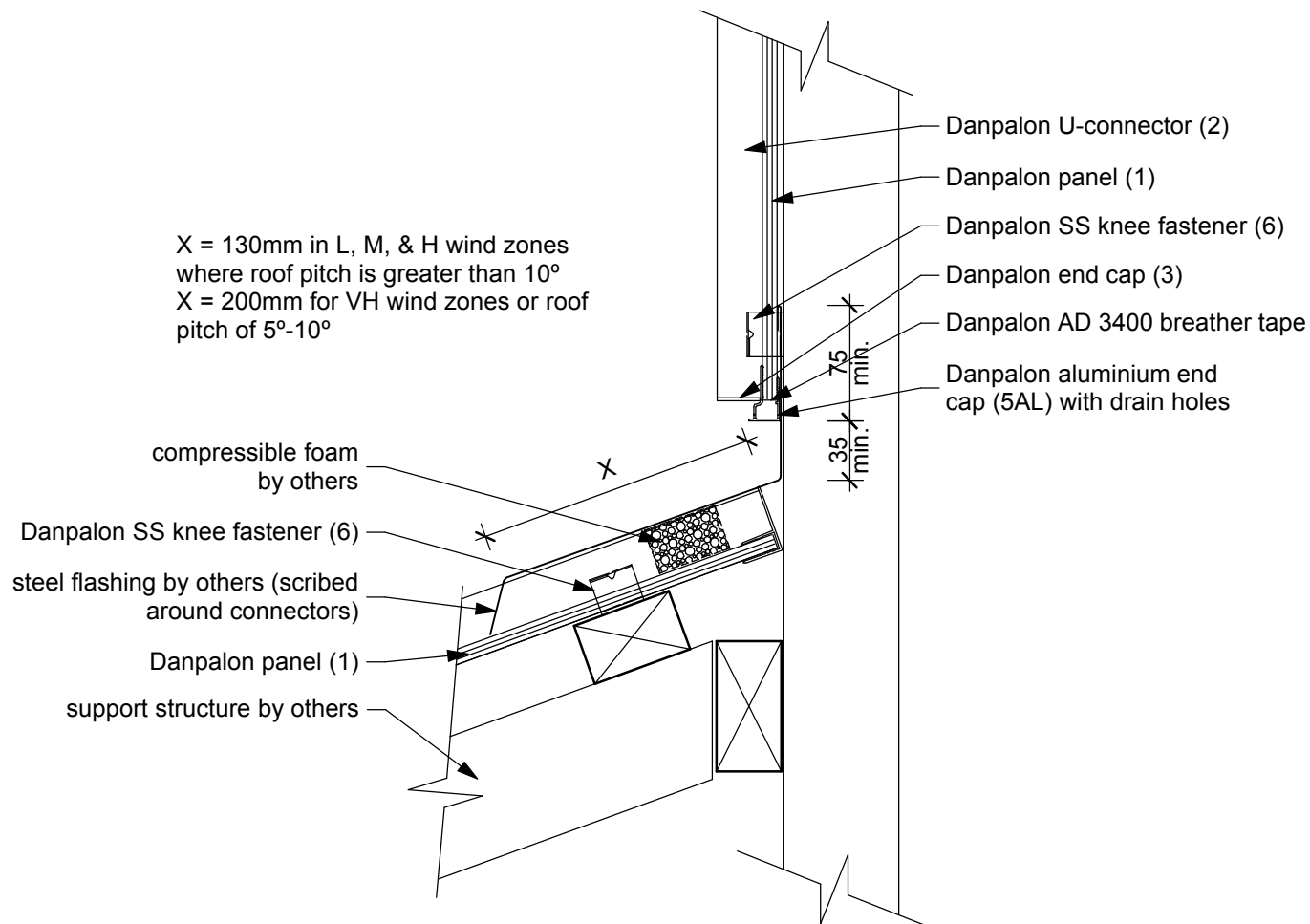

TRANSVERSE APRON FLASHING 1:5

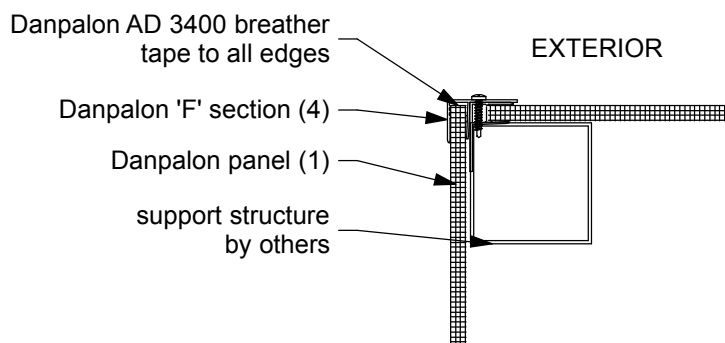

EXTERNAL CORNER

1:5

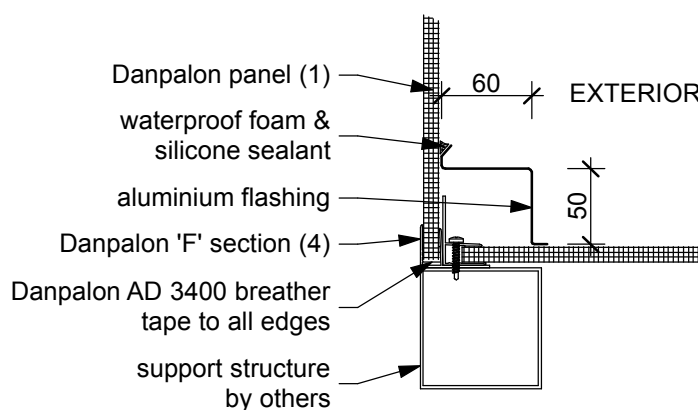

INTERNAL CORNER

1:5

Note:
Where post is timber use a
50x50 PVC corner flashing
behind Danpalon.

IMPORTANT RECOMMENDATION: For internal
and external corner sections view the New
Everlight Facade Details on our website
www.everlight.co.nz

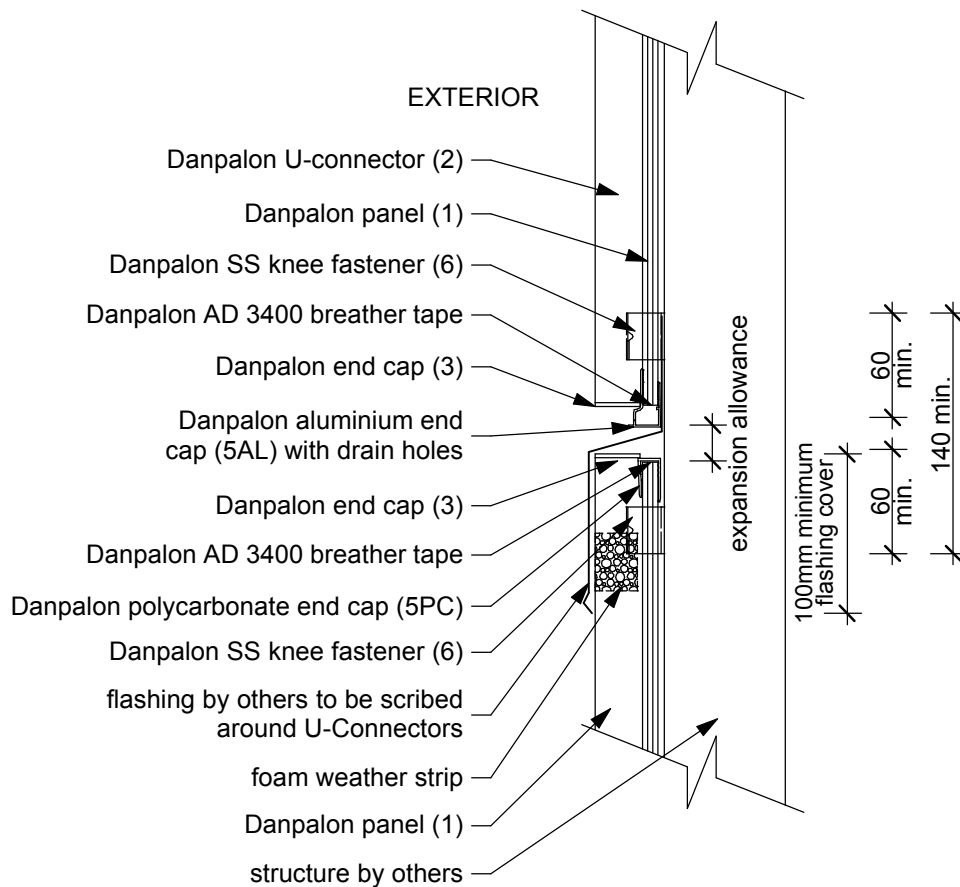

HORIZONTAL CLADDING JOINT

1:5

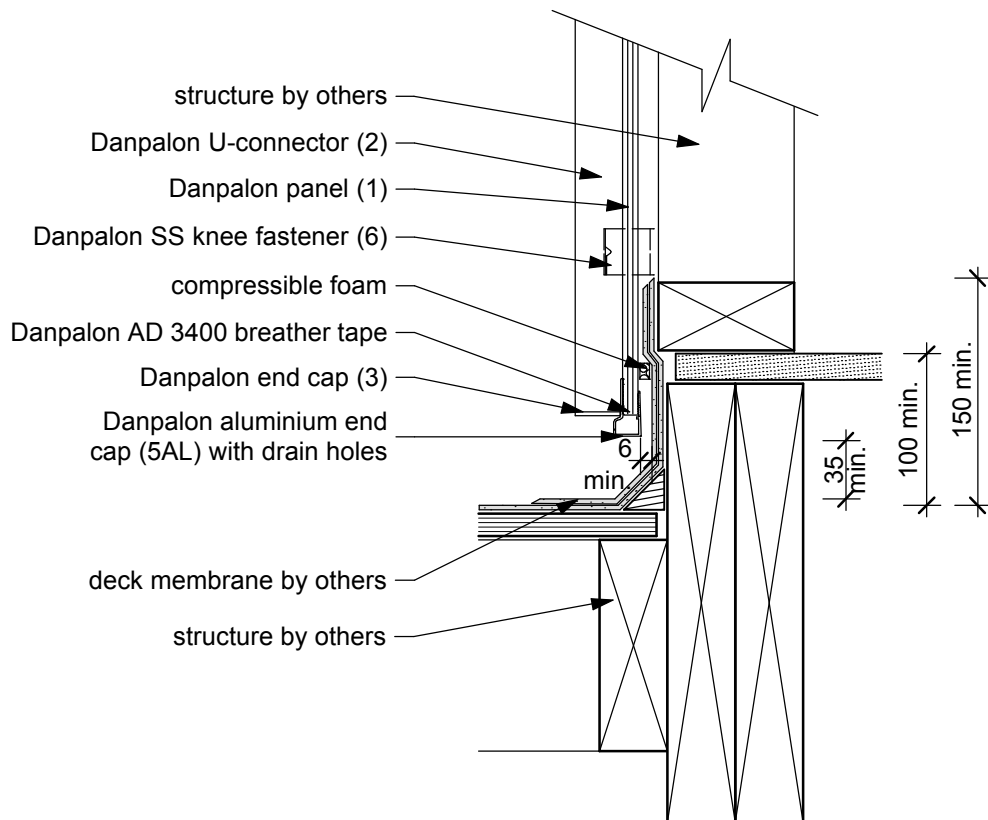

WALL CLADDING TO BALCONY

1:5

Reference Detail Figure 62
Acceptable Solution E2/AS1

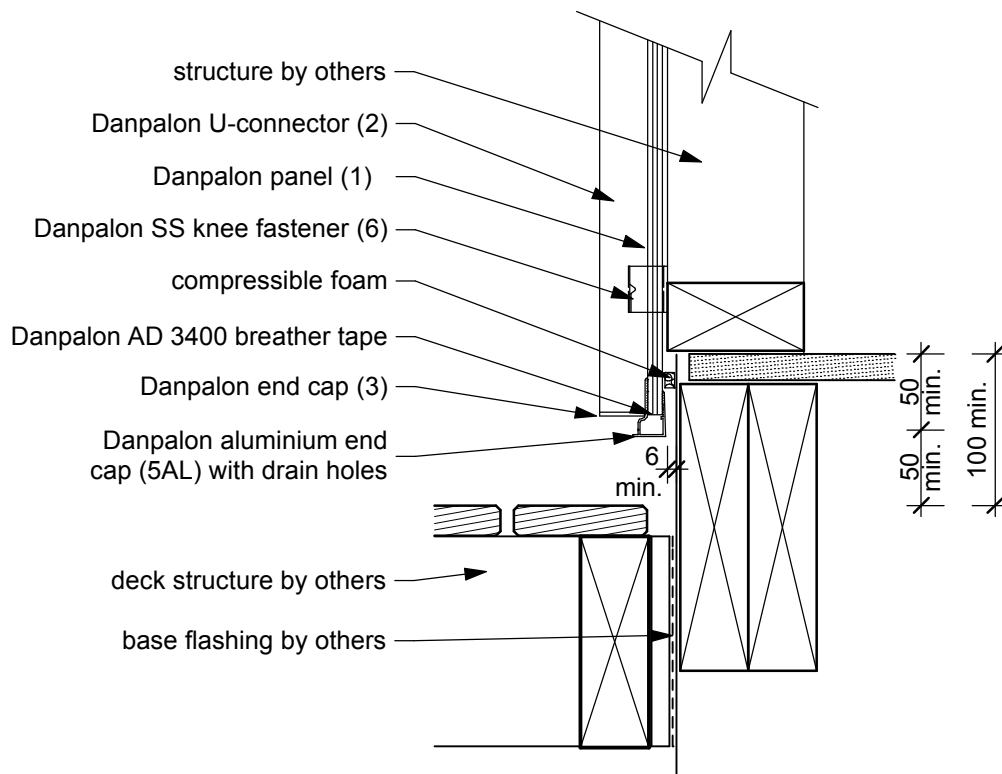

WALL CLADDING TO DECK

1:5

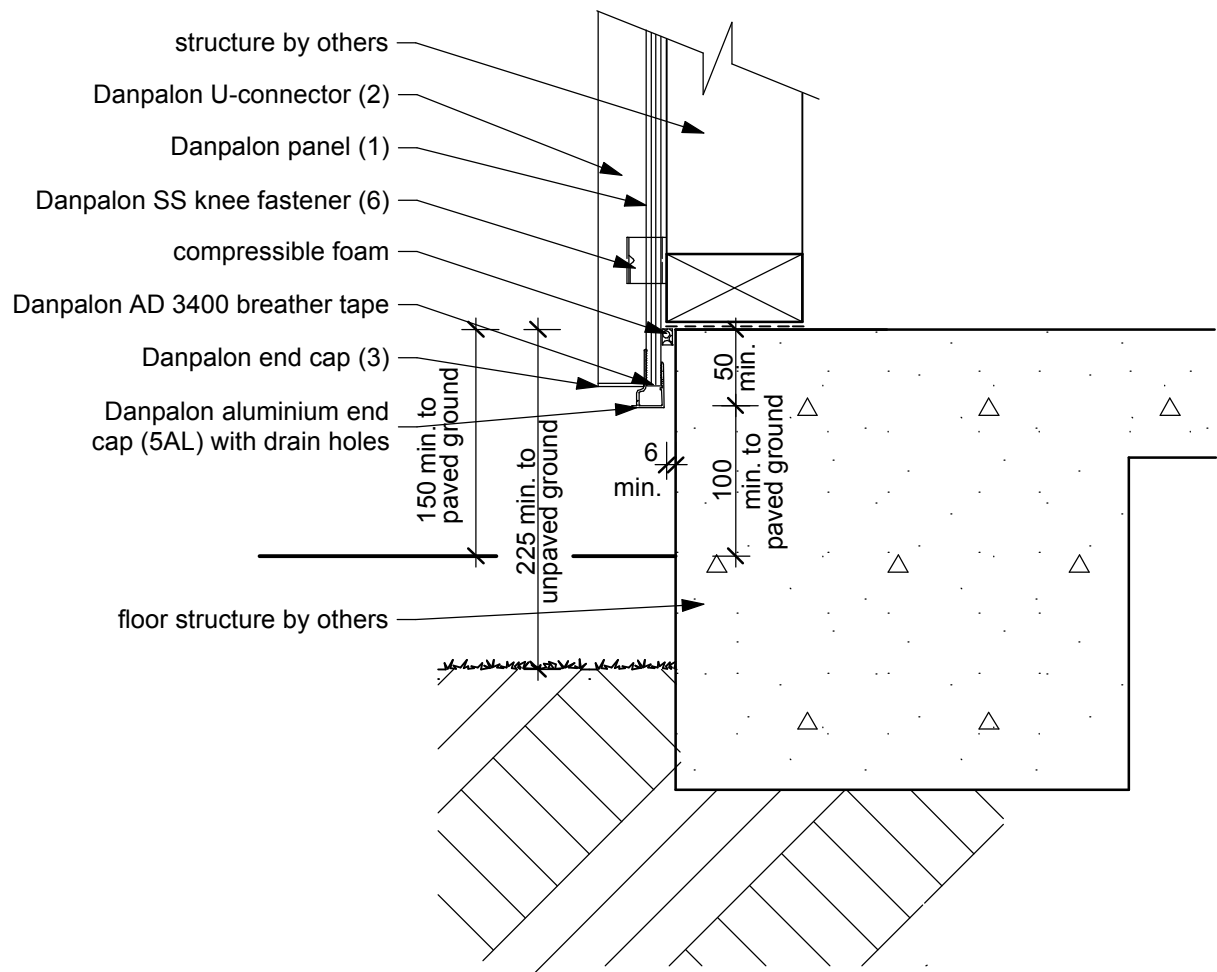

WALL CLADDING TO GROUND

1:5

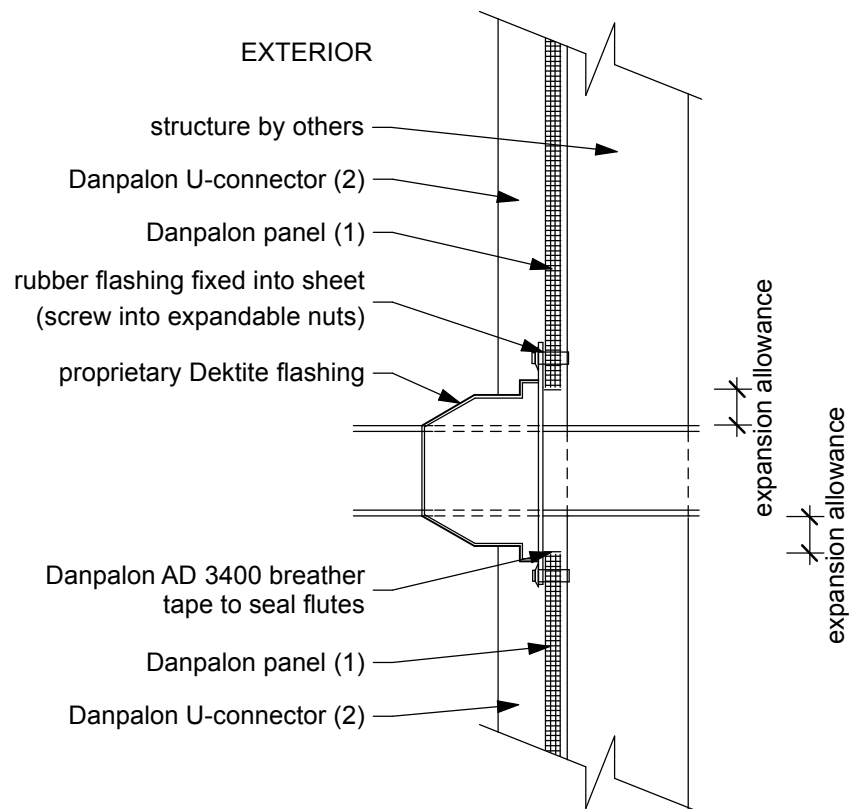

WALL CLADDING PENETRATION

1:5

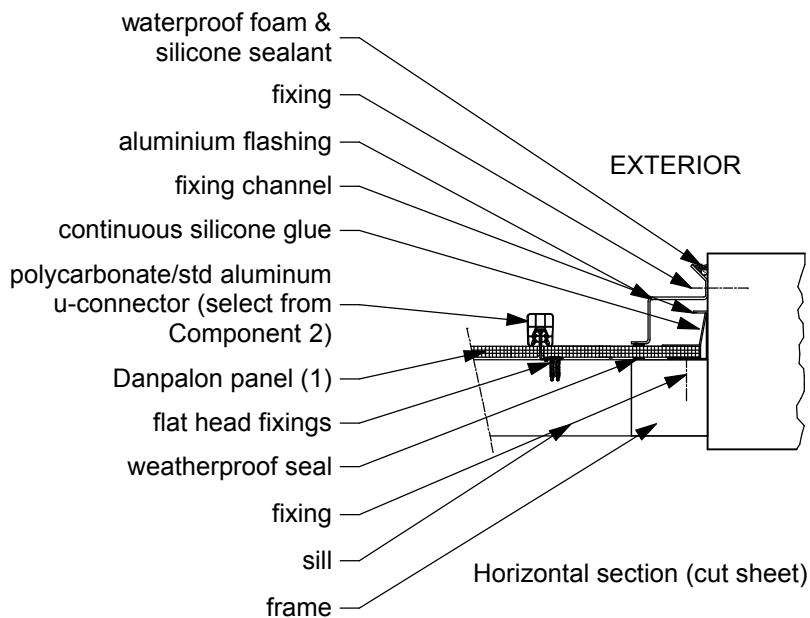
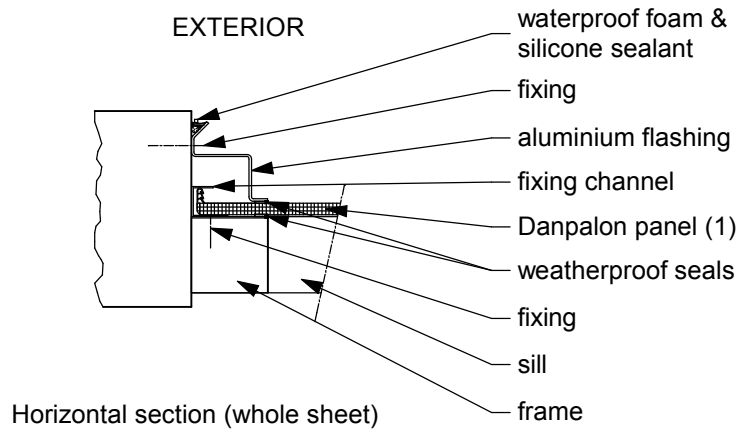

VERTICAL CLADDING - EXTERNAL CONNECTORS

1:5

Note: size of flashings, steel profiles and weatherproof seals to be designed by professionals

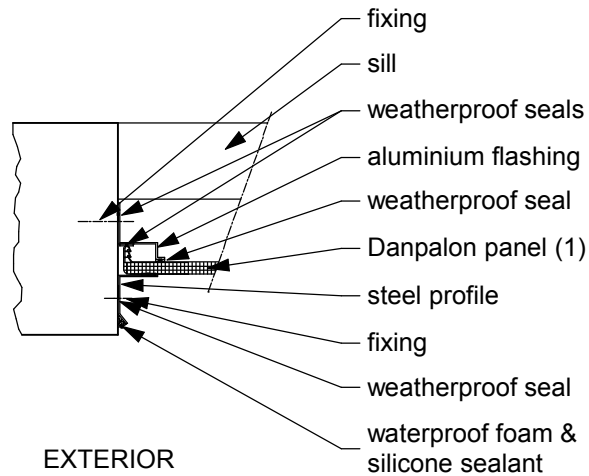

Note: These designs require the Danpalon panels to be manufactured with the UV-protection on the external face of the panel.

Horizontal section (whole sheet)

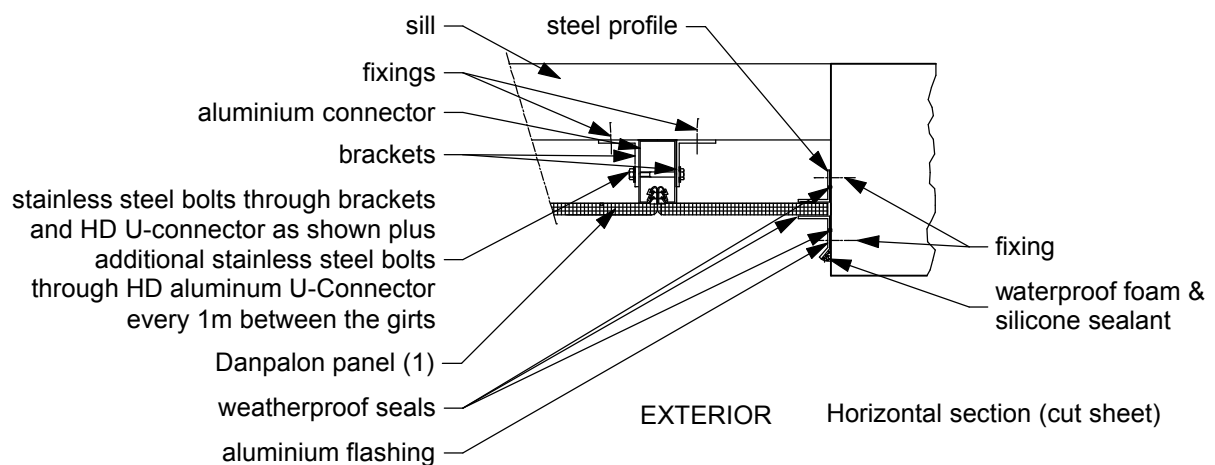

Horizontal section (cut sheet)

VERTICAL CLADDING - INTERNAL CONNECTORS

1:5

Note: size of flashings, steel profiles and weatherproof seals to be designed by professionals

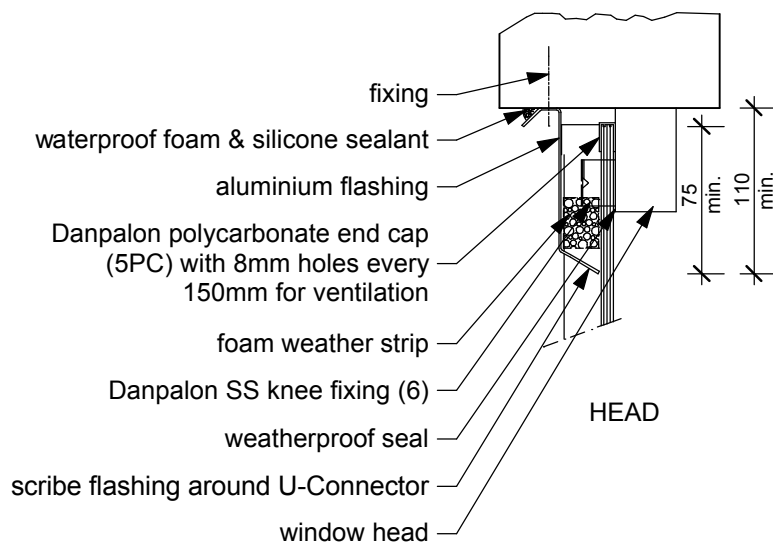

EXTERIOR

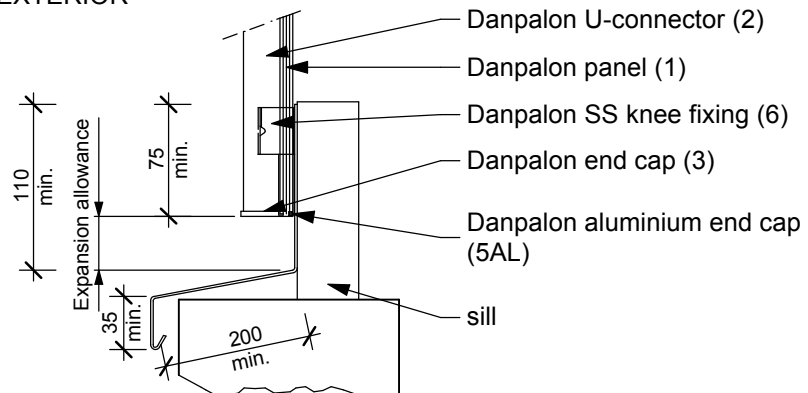

SILL

VERTICAL GLAZING - HEAD & SILL

1:5

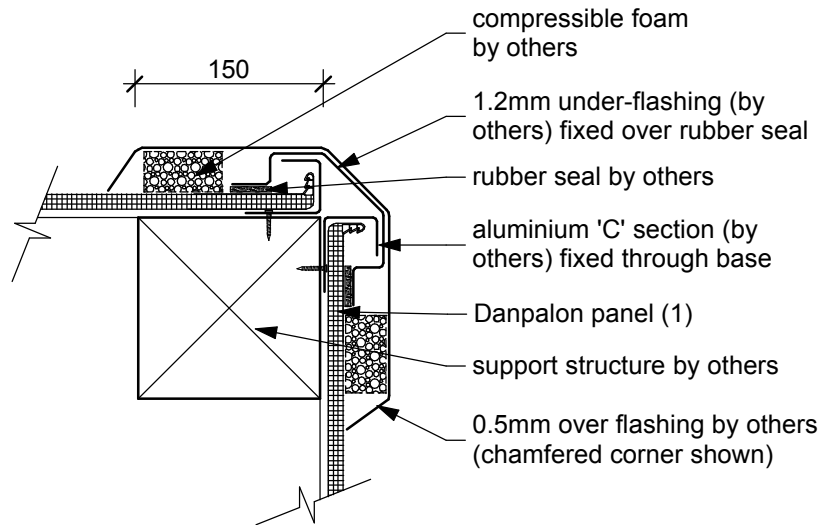

WHOLE SHEET WITH UPSTAND

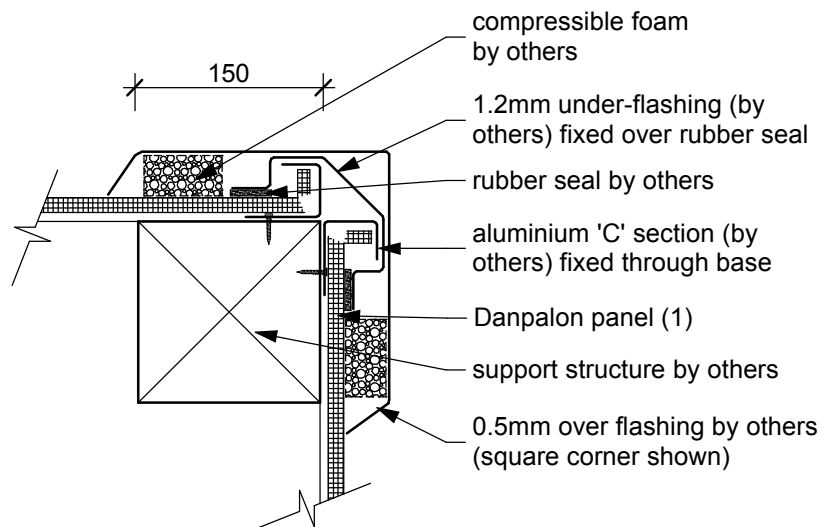

CUT SHEET WITH UPSTAND

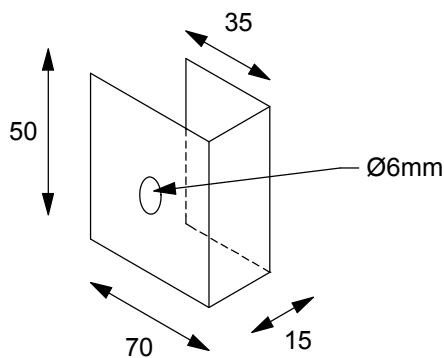

ALUMINIUM 'C' SECTION

EXTERNAL CORNER DETAIL

1:5

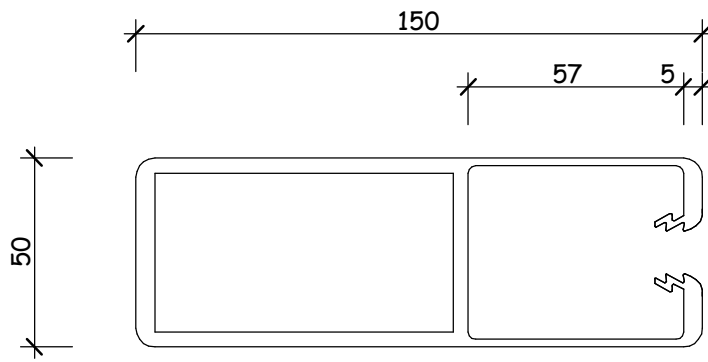

DIMENSIONS
1:2

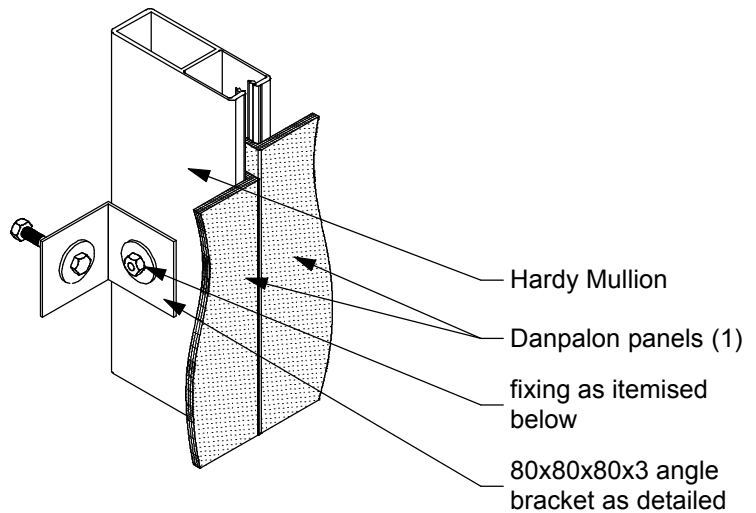

ISOMETRIC
· not to scale

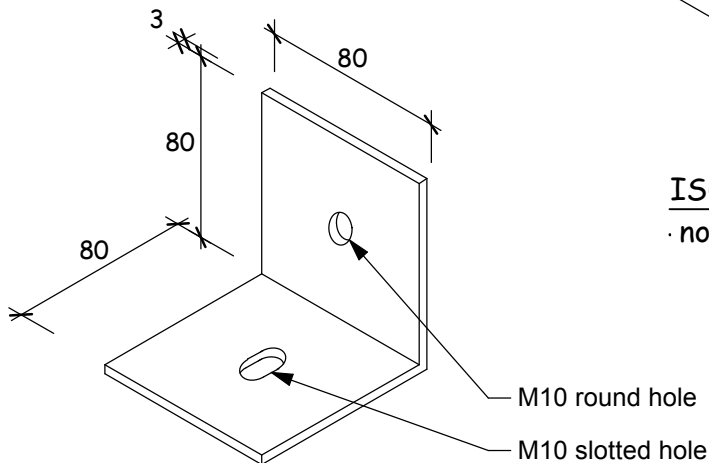

ANGLE BRACKET
not to scale

Angle Brackets:
80x80x80x3mm galvanised steel or
aluminium
Fixing:
M10x70 316 stainless steel hex bolt
M10 316 stainless steel Nylok nut
M10x21x1.2 316 stainless steel flat washer

HARDY MULLION
scales as shown

Danpalon panels (1)

polycarbonate/std aluminum
u-connector (select from
Component 2)

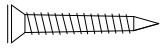

Screw fasteners

Powers fasteners SDS EZIFIND NO 255

20 tpi 14 ga 25mm long thread class 4

For coastal areas use SDS EZIFIND NO

912 part nosssdhnc1220 Bi Metal

AB Bar (11b)

Danpalon aluminium end
cap (5) with drain holes

Danpalon panels (1)

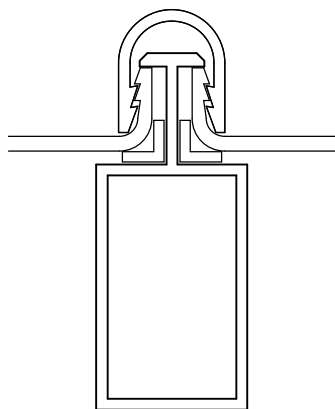

4mm solid

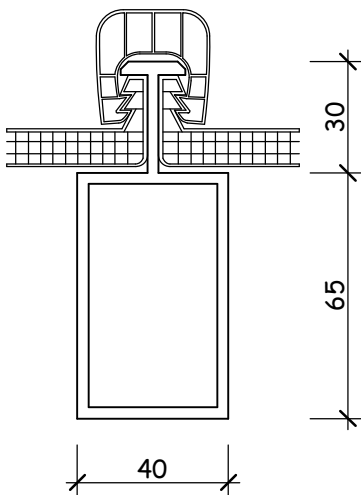

8mm or 10mm multicell

AB BAR DIMENSIONS

1:2

ISOMETRIC

not to scale

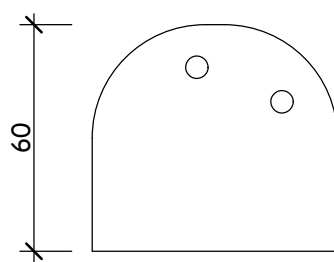

side elevation 1

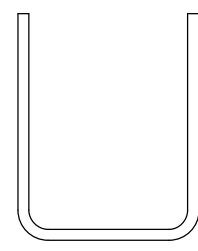

side elevation 2

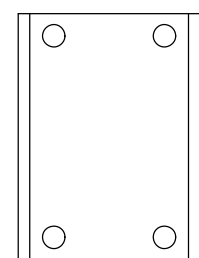

plan view

SADDLE BRACKET DIMENSIONS

1:2

AB BAR

scales as shown